

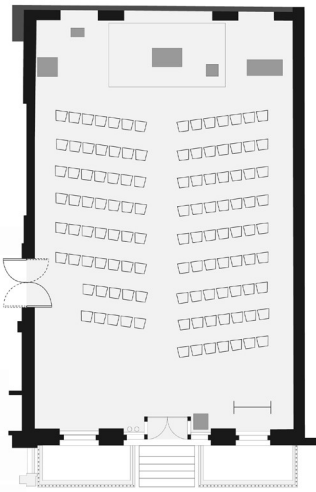

Swedenborg Hall

GROUND FLOOR | theatre-style layout



This graceful, ground-floor lecture hall accommodates up to 100 people in grand, neo-classical surrounding. The antique wooden chairs, oak panelling and pine flooring add character to the space and a Boston Steinway upright piano is also available for hire. Swedenborg Hall's features include:

- Mechanized skylight blinds
- Full blackout for film screenings or PowerPoint presentations
- Stage platform (3m x 2m with 20cm height)
- Wireless WUXGA full HD plus projector
- Screen wall - 1.98m wide
- PA system with Wharfedale speakers
- CAT 5 connection (HDMI, USB C, VGA & XLR audio)
- 2 professional Shure wired microphones
- Microphone stands
- Lectern microphone
- 6 trestle tables
- On-site concierge support
- Complimentary wifi

HIRE RATES

SINGLE SESSION BOOKINGS

| | |
|------------------|------------|
| 9.00am - 1.00pm | £550 + VAT |
| 1.00pm - 6.00pm | £550 + VAT |
| 6.00pm - 10.00pm | £550 + VAT |

TOTAL PER SESSION £660 incl. VAT

ALL DAY BOOKINGS

| | |
|------------|-------------|
| 9am - 10pm | £1360 + VAT |
|------------|-------------|

TOTAL PER SESSION £1632 incl. VAT

DOUBLE SESSION BOOKINGS

| | |
|------------------|------------|
| 9.00am - 6.00pm | £950 + VAT |
| 1.00pm - 10.00pm | £950 + VAT |

TOTAL PER SESSION £1140 incl. VAT

AMENITIES

Digital projector/audio package | **£65 + VAT**

Piano | **£50 + VAT**

Stage platform | **£120 + VAT**

A discount of 50% is available for registered charities, not-for-profit companies and educational institutions.

Pre-booked refreshments through Arcana Coffee available on request starting from £3.30 per person (teas | coffees) £4.50 per person (teas | coffees | pastries).

If you would like more information on Swedenborg Hall, or would like to book it, then please contact Swedenborg House on +44 (0) 20 7405 7986 or email admin@swedenborg.org.uk.

- **NAME:** Swedenborg Hall
- **CAPACITY:** 100
- **CHAIRS:** 100
- **DIMENSIONS:** 8.7m x 13m
(113.1m², 1217.4ft²)
- **ENTRANCE:** Barter Street
- **ACCESSIBILITY:** Assisted wheelchair access to ground floor only, entrance through the bookshop upon prior request
- **TOILETS:** Gents in basement, Ladies first floor
- **NEAREST TUBE:**
Holborn /
Tottenham Court Road
- **ADDRESS:**
Swedenborg House
The Swedenborg Society
20/21 Bloomsbury Way
London WC1A 2TH
tel: 0207 405 7986
www.swedenborg.org.uk

Follow us on:

