

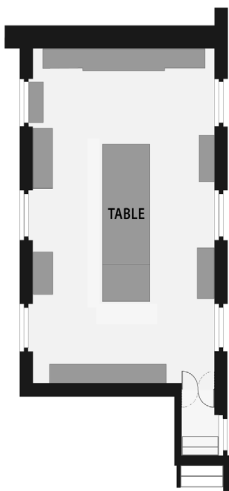

The David Wynter Room

SECOND FLOOR | boardroom style layout



This light and spacious, second-floor conference room accommodates up to 25 people. High ceilings and natural light make the Wynter Room ideal for smaller lectures and committee meetings. This room contains the Swedenborg Collection of the Society's library, display cabinets and key items from the Society's collection of museum artefacts. The room also features:

- **NAME:** The David Wynter Room
- **CAPACITY:** 25 people; 14 seated around table
- **CHAIRS:** 25
- **DIMENSIONS:** 6.3 x 8.8 m (55.44 m², 596.75 ft²)
- **ENTRANCE:** Barter Street
- **ACCESSIBILITY:** Wheelchair access to ground floor only, entrance through the bookshop, upon prior request
- **TOILETS:** Gents in basement, Ladies first floor
- **NEAREST TUBE:** Holborn / Tottenham Court Road
- **ADDRESS:** Swedenborg House
The Swedenborg Society
20/21 Bloomsbury Way
London WC1A 2TH
tel: 0207 405 7986
www.swedenborg.org.uk

- Exhibition spot lighting
- Window blinds
- 14-seat mahogany antique boardroom table
- HD projector with portable screen
- Overhead and slide projector and whiteboards are available to hire for an additional charge
- Complimentary wifi

HIRE RATES

SINGLE SESSION BOOKINGS

9.00am - 1.00pm		£300 + VAT
1.00pm - 6.00pm		£300 + VAT
6.00pm - 10.00pm		£300 + VAT

TOTAL PER SESSION £360 incl. VAT

ALL DAY BOOKINGS

9am - 10pm		£600 + VAT
------------	--	------------

TOTAL PER SESSION £720 incl. VAT

DOUBLE SESSION BOOKINGS

9.00am - 6.00pm		£400 + VAT
1.00pm - 10.00pm		£400 + VAT

TOTAL PER SESSION £480 incl. VAT

AMENITIES

Slide, digital or overhead projector with portable screen | **£40 + VAT**

Flipchart | **£7 + VAT**

Kitchen | **£30 + VAT**

Follow us on:



If you would like more information on the David Wynter Room, or would like to book it, or use it as a filming venue, then please contact Swedenborg House on +44 (0) 20 7405 7986 or email admin@swedenborg.org.uk.